

# dji MIC MINI 2

Quick Start Guide  
快速入门指南  
Guide de démarrage rapide  
v1.0

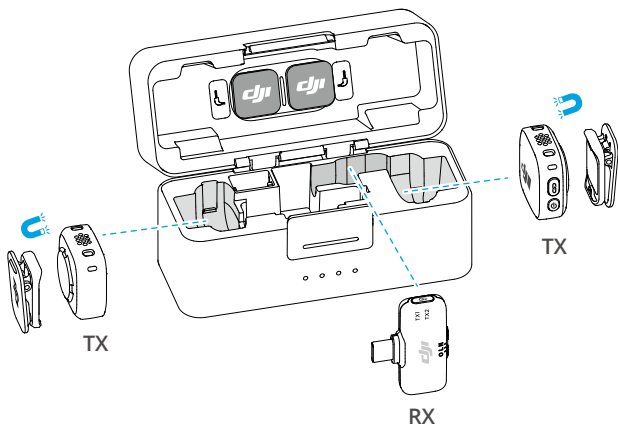

2 TX + 1 Mobile RX + Charging Case | 手机版两发一收, 含充电盒 | 2 TX + 1 RX mobile + Boîtier de recharge

Instrukcja obsługi

A

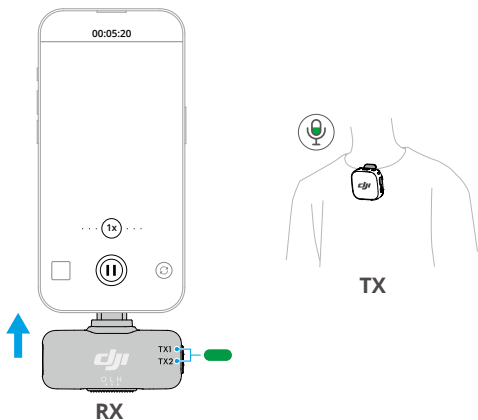

B

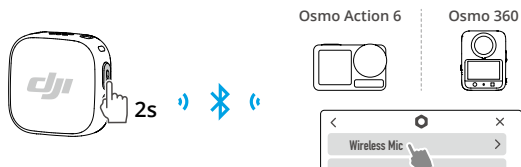

OsmoAudio Compatibility List  
OsmoAudio 兼容列表  
Liste de compatibilité DJI OsmoAudio



<https://www.dji.com/mic-mini-2/downloads>

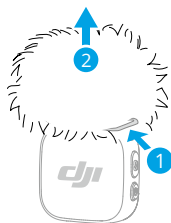
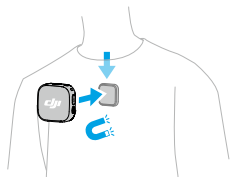
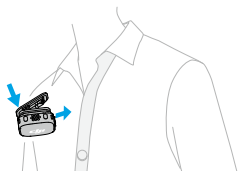



<https://s.dji.com/guide128>

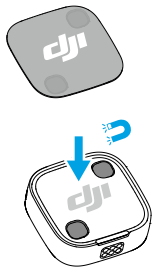
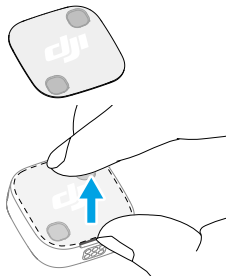

## TX

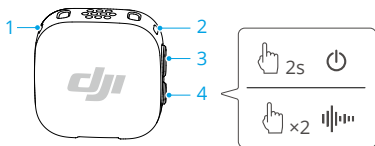

## RX

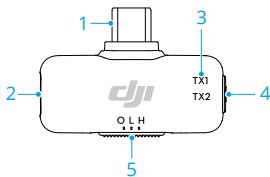

## Charging Case

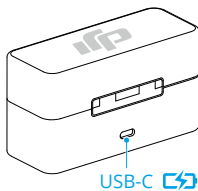
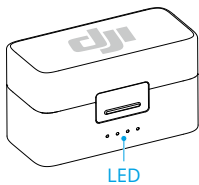

EN

## TX

1. Noise Cancellation LED
2. System Status LED
3. Linking Button
4. Power Button

## RX

1. USB-C Plug
2. USB-C Charging Port
3. Transmitter Status LED
4. Linking Button
5. Noise Cancellation Mode Switch

CHS

## TX

1. 降噪状态指示灯
2. 系统状态指示灯
3. 配对按键
4. 电源按键

## RX

1. USB-C 接头
2. USB-C 充电接口
3. 发射器状态指示灯
4. 配对按键
5. 降噪档位切换开关

FR

## TX

1. LED de suppression du bruit
2. LED d'état du système
3. Bouton d'appairage
4. Bouton d'alimentation

## RX

1. Fiche USB-C
2. Port de charge USB-C
3. LED d'état du transmetteur
4. Bouton d'appairage
5. Changement de mode de suppression du bruit

PL

## TX

1. Dioda LED redukcji szumów
2. Dioda LED stanu systemu
3. Przycisk łączenia
4. Przycisk zasilania

## RX

1. Wtyczka USB-C
2. Interfejs ładowania USB-C
3. Wskaźnik stanu nadajnika LED
4. Przycisk łączenia
5. Przełącznik trybu redukcji szumu



DJI SUPPORT



微信扫一扫  
获取技术支持

This content is subject to change without prior notice.

DJI is a trademark of DJI.

Copyright © 2025 DJI All Rights Reserved.

Ce contenu est susceptible d'être modifié sans préavis.

DJI est une marque commerciale de DJI.

Copyright © 2025 DJI Tous droits réservés.



YCBZ5500368503