

DJI MIC MINI 2

Quick Start Guide

快速入门指南

Guide de démarrage rapide

v1.0

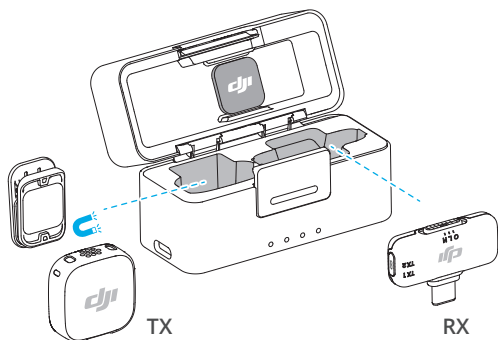

1 TX + 1 Mobile RX + Charging Case | 手机版一发一收, 含充电盒 | 1 TX + 1 RX mobile + Boîtier de recharge

Instrukcja obsługi

A

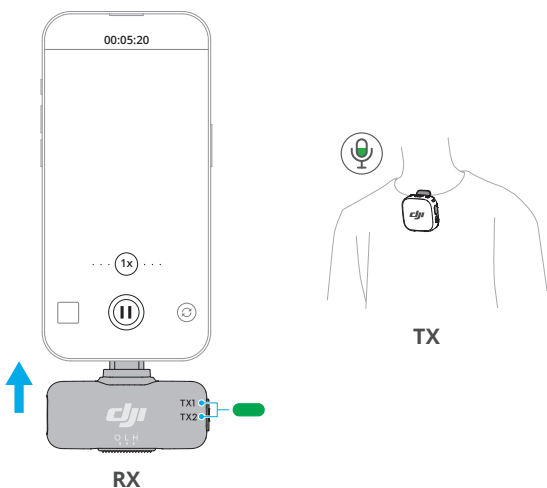

B

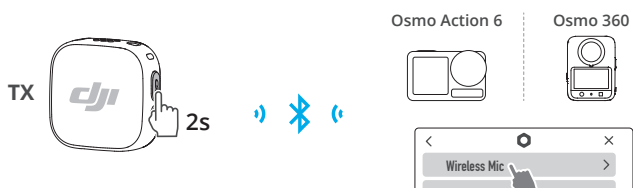

OsmoAudio Compatibility List
Osmaudio 兼容列表
Liste de compatibilité DJI Osmaudio



<https://www.dji.com/mic-mini-2/downloads>

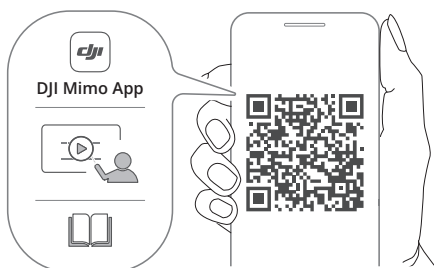
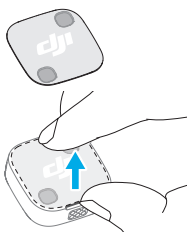
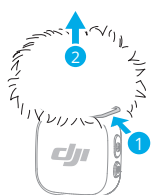
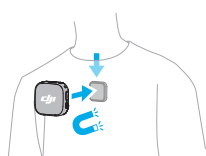
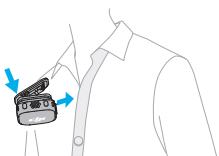

<https://s.dji.com/guide128>

TX

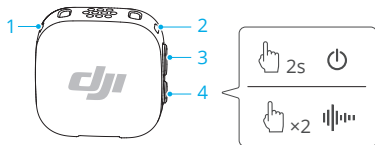

RX

Charging Case

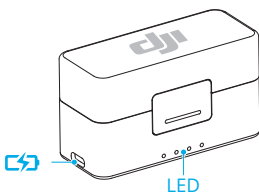
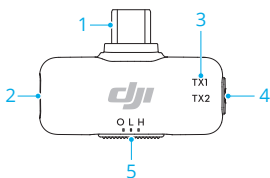

EN

TX

1. Noise Cancellation LED
2. System Status LED
3. Linking Button
4. Power Button

CHS

TX

1. 降噪状态指示灯
2. 系统状态指示灯
3. 配对按键
4. 电源按键

FR

TX

1. LED de suppression du bruit
2. LED d'état du système
3. Bouton d'appairage
4. Bouton d'alimentation

PL

TX

1. Dioda LED redukcji szumów
2. Dioda LED stanu systemu
3. Przycisk łączenia
4. Przycisk zasilania

RX

1. USB-C Plug
2. USB-C Charging Port
3. Transmitter Status LED
4. Linking Button
5. Noise Cancellation Mode Switch

RX

1. USB-C 接头
2. USB-C 充电接口
3. 发射器状态指示灯
4. 配对按键
5. 降噪档位切换开关

RX

1. Fiche USB-C
2. Port de charge USB-C
3. LED d'état du transmetteur
4. Bouton d'appairage
5. Changement de mode de suppression du bruit

RX

1. Wtyczka USB-C
2. Interfejs ładowania USB-C
3. Wskaźnik stanu nadajnika LED
4. Przycisk łączenia
5. Przełącznik trybu redukcji szumu

This content is subject to change without prior notice. DJI is a trademark of DJI.

Copyright © 2025 DJI All Rights Reserved.

Ce contenu est susceptible d'être modifié sans préavis. DJI est une marque commerciale de DJI.

Copyright © 2025 DJI Tous droits réservés.

DJI Support/ 技术支持
<https://www.dji.com/support>



YCB2SS00366703