

DJI Power Series

Energy Optimization User Manual

v1.0 2025.07

1 Setting Up an Energy Optimization Plan

The Energy Optimization function in DJI Home App allows you to manage the charging and discharging plan of the power station, helping to reduce electricity costs.

1.1 Scheduled Periods

When enabled, the power station will automatically charge and discharge according to the set peak and off-peak electricity rate periods.

1. Turn on the power station and ensure that it is connected to DJI Home App.
2. Make sure the power station and the mobile phone is connected to Wi-Fi. Update the device firmware to the latest version.
3. Run DJI Home App, tap  at the top-right corner, and tap **Energy Optimization > Scheduled Periods**.

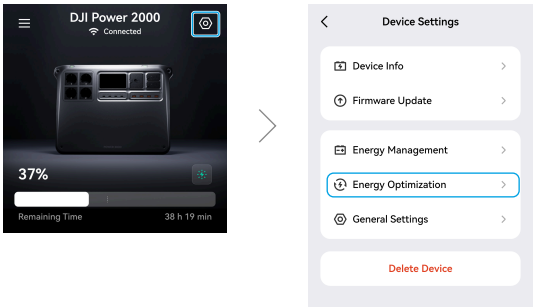

4. Set the peak and off-peak electricity rate periods. During peak periods, the power station supplies power to connected appliances; while in off-peak periods, the power station will be charged.

Peak Electricity Rate Periods

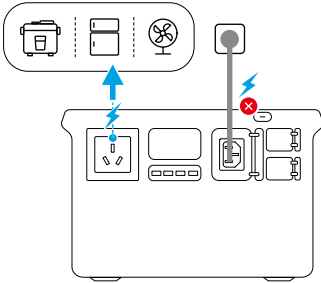

Off-Peak Electricity Rate Periods

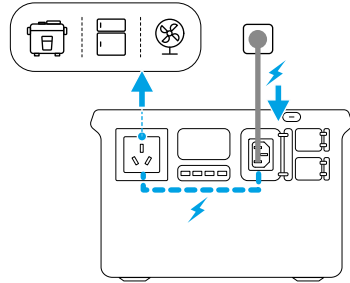

1.2 Grid-Tied ESS

A solar power system is required to use the Grid-Tied ESS function. The power station can be connected to the grid to maximize the use of solar energy and reduce electricity costs.

Grid-Tied functions are only supported in some countries and regions. Visit the link for more details <https://www.dji.com/power-2000/faq>.

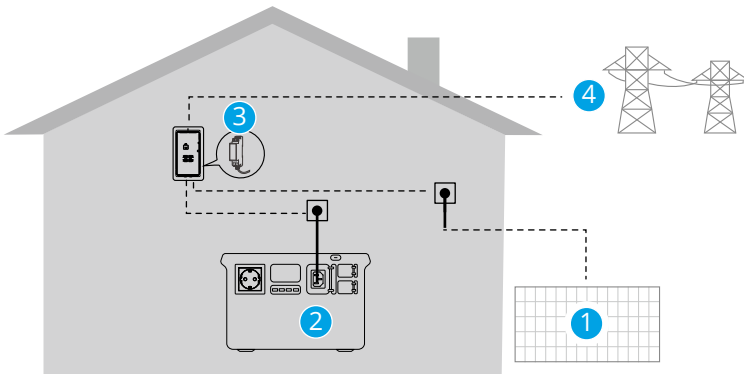

1. Solar Power System
2. Power Station
3. Smart Meter
4. Power Grid

Getting Started

1. Connect the power station to a wall socket and tighten the screws on the AC input port.

 • DO NOT connect to extension cords or sockets with aging wiring.

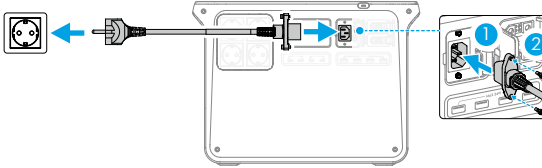

2. Install a smart meter (optional).

-  • Visit the link to view supported smart meter models <https://www.dji.com/power-2000/faq>.
 - Refer to the smart meter manuals to learn about safe installation and usage. Installations should be completed by a qualified electrician.
 - It is recommended to consult the electrician or power company to determine the actual operating meter phase for further settings in the app.
-

3. Before using the grid-tied function, make sure to submit a power grid connection request in compliance with local laws and regulations. The requirements and procedures may vary by country and region. Consult your local power company for more details.

Grid-Tied Settings

1. Turn on the power station and ensure that it is connected to DJI Home App.
2. Make sure the power station and the mobile phone is connected to Wi-Fi. Update the device firmware to the latest version.

3. Run DJI Home App, tap  at the top-right corner, and tap **Energy Optimization > Grid-Tied ESS**.

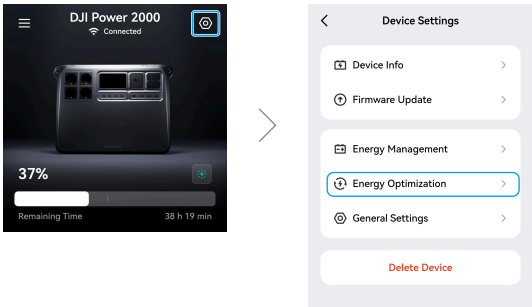

4. Select the grid-tied mode:

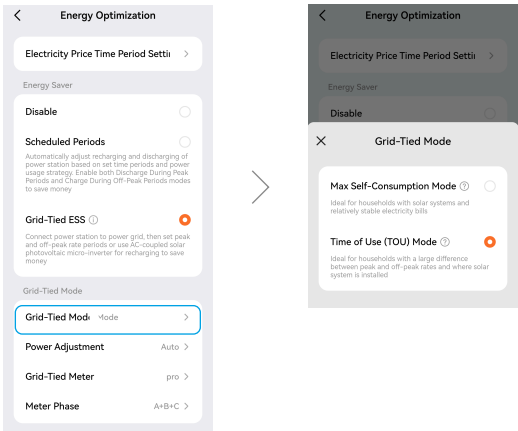

Electricity Prices	Smart Meter	Recommended Settings
With peak and off-peak difference	No	Time of Use (TOU) Mode Power Adjustment: Manual
	Yes	Time of Use (TOU) Mode Power Adjustment: Auto
No peak or off-peak difference	Yes	Max Self-Consumption Mode

* Select Scheduled Periods if no solar power system is installed.

Both **max self-consumption** and **TOU** will adjust the charging and discharging of the power station based on household electricity usage. The electricity from the solar power system or the power station will be used in priority to reduce grid consumption and electricity costs.

Compared to **max self-consumption**, **TOU** mode further optimizes power usage based on the electricity price schedules. The power station charges with surplus solar power during the day and low-cost grid power during off-peak periods, then supplies stored energy to household appliances during peak periods to reduce grid consumption and save on electricity costs.

5. Complete the settings following the instructions in DJI Home App.

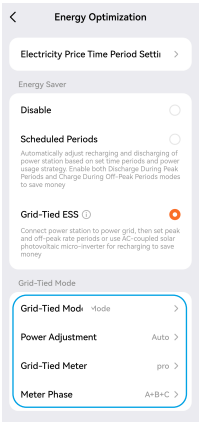

6. Sync the smart meter to the app and refer to the illustration for check box selection.

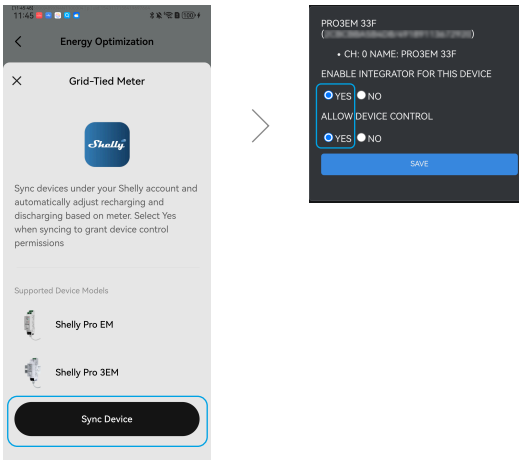

⚠ • When grid-tied, the output power of the power station will be 800 W and the max charging power will be 2200 W.

- UPS function still can be used in grid-tied mode. Just make sure that the total power consumption of devices connected to the AC output port of the power station does not exceed 1200 W, otherwise it may affect grid-tied performance.
 - When you need to disconnect the power station from the grid for outdoor or vehicle use, it is recommended to disable the energy optimization settings for stable power output.
-