

INSPIRE 1

1345 Propeller Locks Quick Start Guide

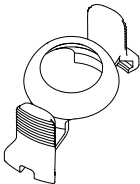

The Inspire 1 Propeller Lock is designed to secure the 1345 propellers in place during flight.

Installation:

1. Tighten the propellers on the motor by hand, and ensure they are securely mounted before installing the propeller locks.
2. Align the tips of propeller lock with the ventilation holes on the motor and slide the propeller lock onto the nut of propeller. Press the propeller lock against the motor firmly to ensure it is installed securely.

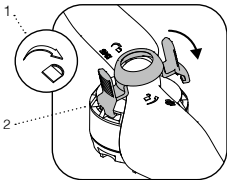

3. Installation complete. Examine to ensure the propeller lock is tight on the motor.

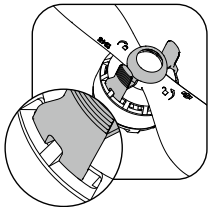

Removal:

Press the tips of the propeller locks to release the lock. After removing, store the propeller locks in a proper place for future use.



Ensure the propeller locks are securely installed before each flight.